

No 107

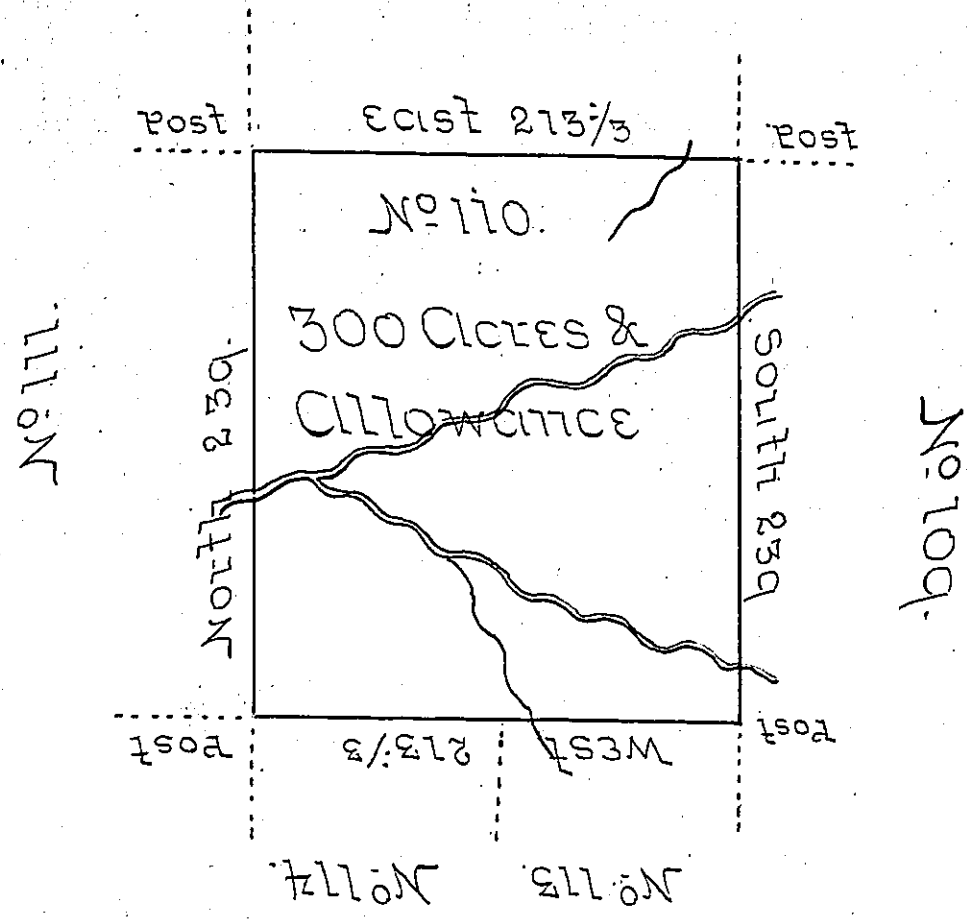

Situate on Little Sowickly Creek Between the thirty-  
 sixth & thirty first Parallel in that Part of District  
 No 3 some Allotted on the North Side of the River  
 Ohio being Part of the Land Appropriated for  
 the Redemption of the Certificates of Deprecia-  
 tion &c<sup>a</sup> Surveyed in June 1785 Pursuant to  
 Instructions from J<sup>no</sup> Lukens Surveyor Gen<sup>l</sup>  
 dated at Philad<sup>a</sup> 5<sup>th</sup> March 1785

Mat<sup>r</sup> Breeding D.S.

*IN TESTIMONY* that the above is a copy of the original remaining on file in  
 the Department of Internal Affairs of Pennsylvania, made  
 conformably to an Act of Assembly approved the 16th day of  
 February, 1833, I have hereunto set my Hand and caused  
 the Seal of said Department to be affixed at Harrisburg,  
 this twenty fifth day of October 1905.

*Asac P. Brown*  
 Secretary of Internal Affairs.